

The capacitors are designed using in medium to high frequency induction heating power supplies. They are conduction cooled via the bus bar.

Reference standard IEC 61071.

Features:

- ◆ Dry type construction polypropylene dielectric, miniature size.
- ◆ Very low series inductance design and high stability.
- ◆ Available continuous work in high current.
- ◆ Conduction cooled type, good to dissipate heat.

ISO 9001:2015 Company



裕昌機電工廠股份有限公司
YUHCHANG ELECTRIC CO., LTD.

總公司: 台灣-台中市清水區中正街59號

TEL:04-26224188

FAX:04-26224646

台北連絡處: 台北市復興南路1段321號二樓

TEL:02-27021616

FAX:02-27066162

高雄連絡處: 高雄市復興一路5之1號

TEL:07-2417766

FAX:07-2915282

Address: 59, CHUNG-CHENG STREET, CHING-SHUI DISTRICT, TAICHUNG CITY 43653, TAIWAN

Tel: +886-4-26224188

Fax: +886-4-26224646

<http://www.capacitor.com.tw>

E-mail: yce919@ms1.hinet.net

Specification:

Type	Nominal Capacitance μF±10% @1kHz	Rated Voltage (Vrms)	Max. Current (Irms)	Max. Power (kVAr)	Frequency Range(kHz) (Full Load)	ESL nH	Dimensions mm			Approx. Weight (kg)	Fig.
							L	W/D	H		
180/200 kVAr											
CC1-11U2502E	0.025	1100	200	180	947~1415	< 3	35	35	30.2	0.2	E
CC1-11U5002E	0.05	1100	200	180	474~708	< 3	35	35	30.2	0.2	E
CC2-10U1003F	0.10	1000	250	200	318~497	< 3	68	30	30	0.5	F
CC2-9U1703E	0.17	900	250	200	231~293	< 3	35	35	30.2	0.2	E
CC2-8U2503E	0.25	800	270	200	199~232	< 3	35	35	30.2	0.2	E
CC2-7U3303E	0.33	700	300	200	197~217	< 3	35	35	30.2	0.2	E
CC2-7U6603F	0.66	700	400	200	98~193	< 3	68	30	30	0.5	F
CC2-6U6603E	0.66	600	350	200	134~148	< 3	35	35	30.2	0.2	E
CC2-6U1334F	1.33	600	450	200	66~121	< 3	68	30	30	0.5	F
CC2-4U2404F	2.40	450	500	200	65~85	< 3	68	30	30	0.5	F
300 kVAr											
CC3-10U2003A	0.20	1000	500	300	238~663	< 5	78	78	34	0.5	A
CC3-10U2003D	0.20	1000	500	300	238~663	< 5	60	60	30	0.5	D
CC3-7U6603A	0.66	700	500	300	148~201	< 5	78	78	34	0.5	A
CC3-6U1004G	1.00	600	650	300	133~224	< 5	75	50	30.2	0.5	G
CC3-6U1304G	1.30	600	650	300	102~172	< 5	75	50	30.2	0.5	G
CC3-5U2604G	2.60	500	650	300	73~86	< 5	75	50	30.2	0.5	G
CC3-4U5004A	5.00	400	800	300	60~68	< 5	78	78	34	0.5	A
CC3-4U5004D	5.00	400	800	300	60~68	< 5	60	60	40	0.5	D
CC3-4U5004G	5.00	400	800	300	60~68	< 5	75	50	30.2	0.5	G
400 kVAr											
CC4-10U1003D	0.10	1000	400	400	637	< 5	60	60	30	0.6	D
CC4-10U2003D	0.20	1000	400	400	318	< 5	60	60	30	0.6	D
CC4-10U3303A	0.33	1000	600	400	194~434	< 5	78	78	34	0.5	A
CC4-10U3303B	0.33	1000	600	400	193~434	< 5	78	78	34	0.5	B
CC4-10U3303D	0.33	1000	600	400	193~434	< 5	60	60	30	0.6	D
CC4-10U6603A	0.66	1000	600	400	96~217	< 5	78	78	34	0.5	A
CC4-10U6603D	0.66	1000	600	400	96~217	< 5	60	60	30	0.6	D
CC4-9U1334D	1.33	900	850	400	59~216	< 5	60	60	30	0.6	D
CC4-8U1004D	1.00	800	650	400	99~168	< 5	60	60	30	0.6	D
CC4-7U2604A	2.60	700	950	400	50~138	< 5	78	78	34	0.5	A
CC4-7U2604D	2.60	700	950	400	50~138	< 5	60	60	30	0.6	D
CC4-5U5004A	5.00	500	1000	400	51~80	< 5	78	78	34	0.5	A
CC4-5U5004D	5.00	500	1000	400	51~80	< 5	60	60	30	0.6	D
500 kVAr											
CC5-11U1404C	1.40	1100	600	500	47~82	< 10	100	100	40	0.6	C
CC5-7U6304H	6.30	700	1000	500	26~51	< 10	53	82	71.5	1.1	H
CC5-7U8504H	8.50	700	1000	500	19~37	< 10	53	92	71.5	1.3	H
CC5-7U1005C	10.0	700	1000	500	16~32	< 10	100	100	40	0.6	C

Specification:

Type	Nominal Capacitance uF±10% @1kHz	Rated Voltage (Vrms)	Max. Current (Irms)	Max. Power (kVAr)	Frequency Range(kHz) (Full Load)	ESL nH	Dimensions mm			Approx. Weight (kg)	Fig.
							L	W/D	H		
600 kVAr											
CC6-10U3303D	0.33	1000	600	600	289	< 10	60	60	40	0.5	D
CC6-10U6603C	0.66	1000	700	600	145~197	< 10	100	100	40	0.6	C
CC6-7U1334D	1.33	700	950	600	147~180	< 10	60	60	40	0.5	D
CC6-7U2604C	2.60	700	1050	600	75~112	< 10	100	100	40	0.6	C
CC6-5U5004C	5.00	500	1200	600	76	< 10	100	100	40	0.6	C
CC6-5U5004D	5.00	500	1200	600	76	< 10	60	60	40	0.5	D

Dimensions:

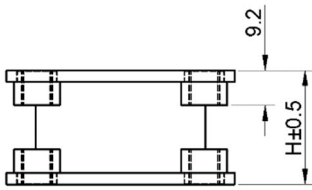
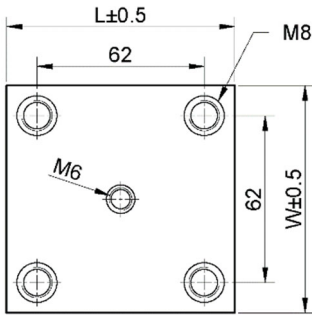

Fig. A

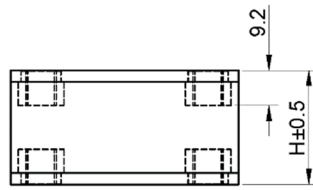
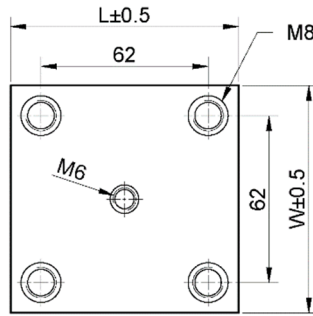

Fig. B

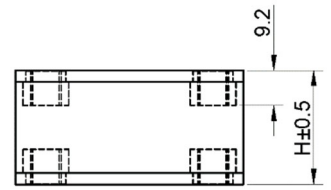
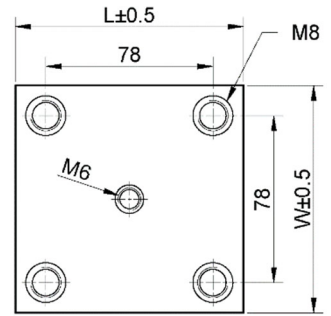

Fig. C

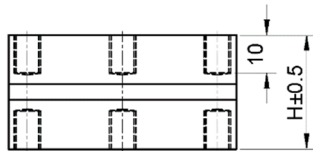
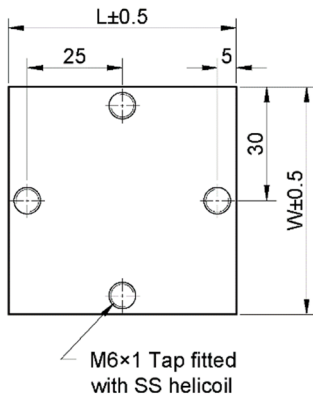

Fig. D

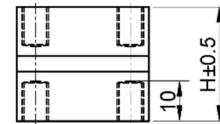
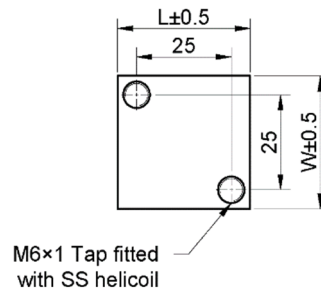

Fig. E

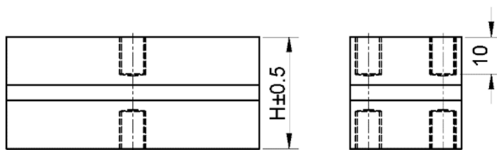
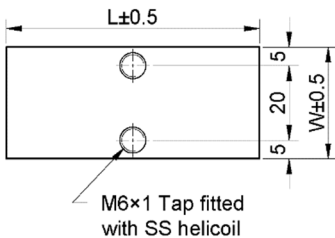

Fig. F

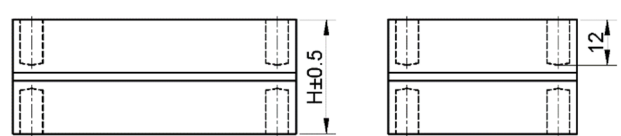
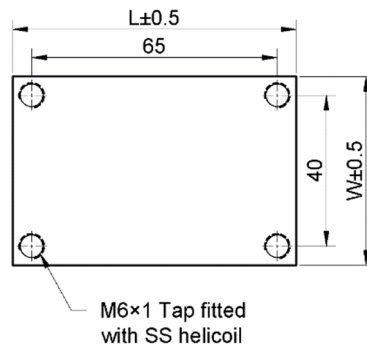

Fig. G

Dimensions:

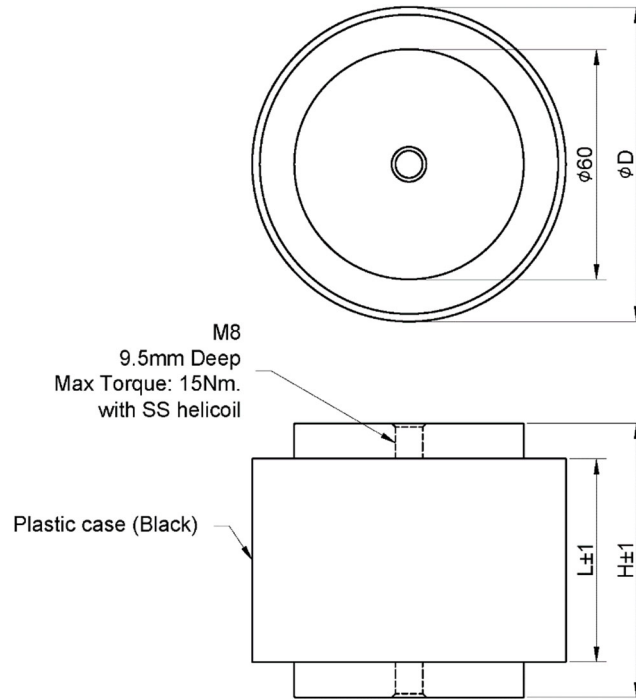
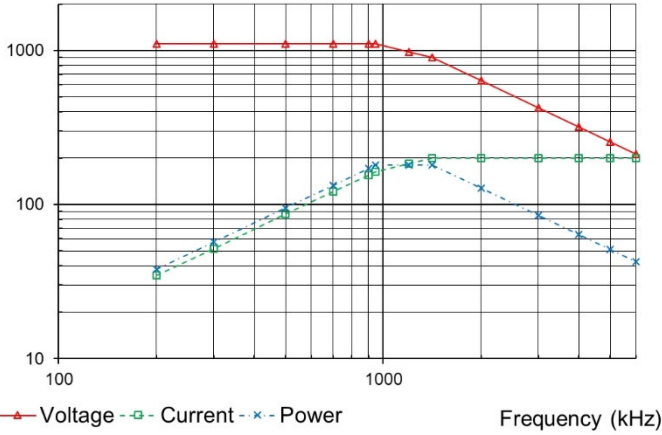

Fig. H

Derating Curves:

200 kVAr

CC1-11U2502E 0.025uF 1100Vrms 200A 180kVAR



CC1-11U5002E 0.05uF 1100Vrms 200A 180kVAR

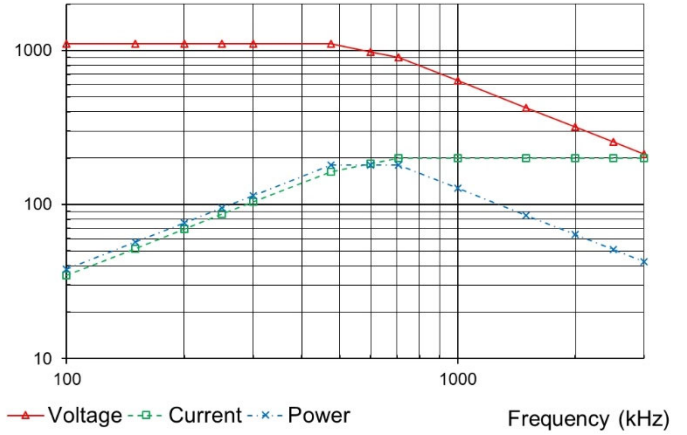

CC2-10U1003F 0.1uF 1000Vrms 250A 200kVAR

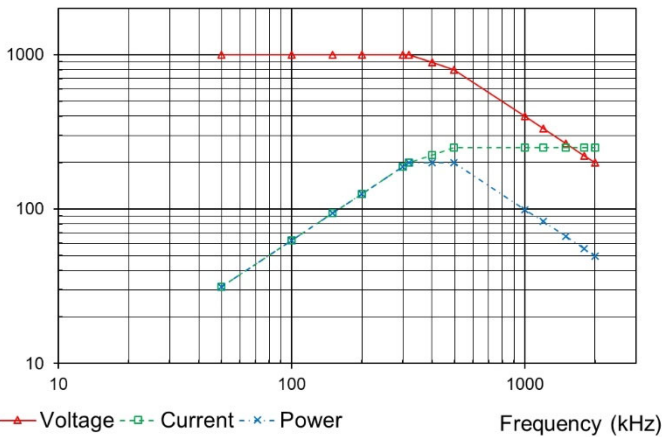

CC2-9U1703E 0.17uF 900Vrms 250A 200kVAR

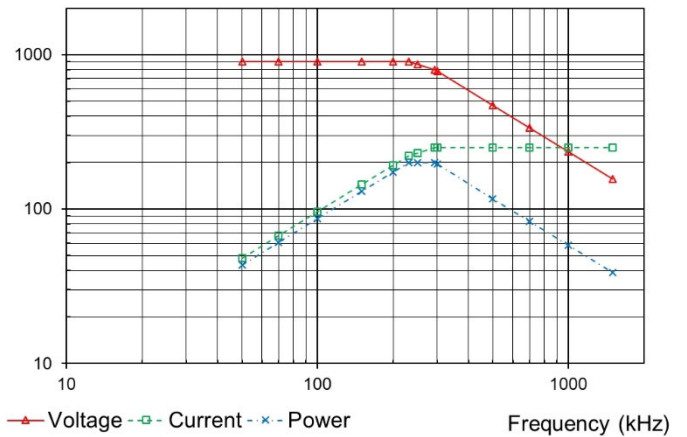

CC2-8U2503E 0.25uF 800Vrms 270A 200kVAR

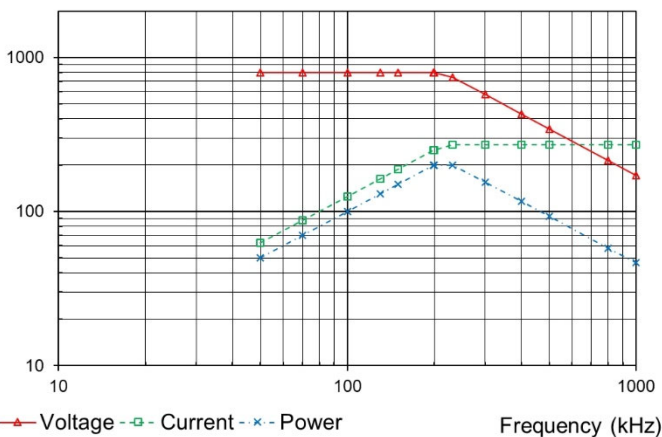

CC2-7U3303E 0.33uF 700Vrms 300A 200kVAR

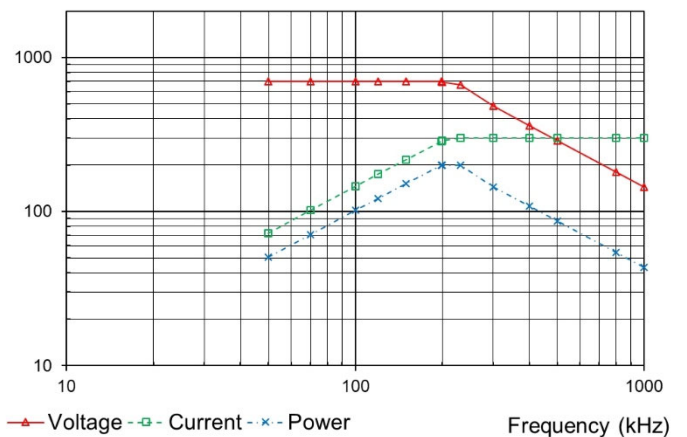

Derating Curves:

200 kVAr

CC2-7U6603F 0.66uF 700Vrms 400A 200kVAR

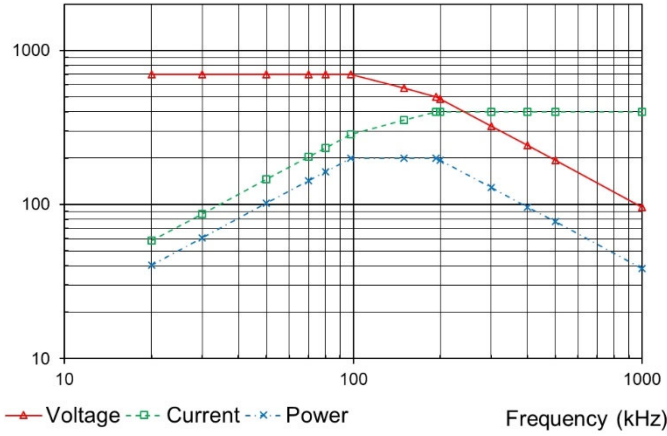

CC2-6U6603E 0.66uF 600Vrms 350A 200kVAR

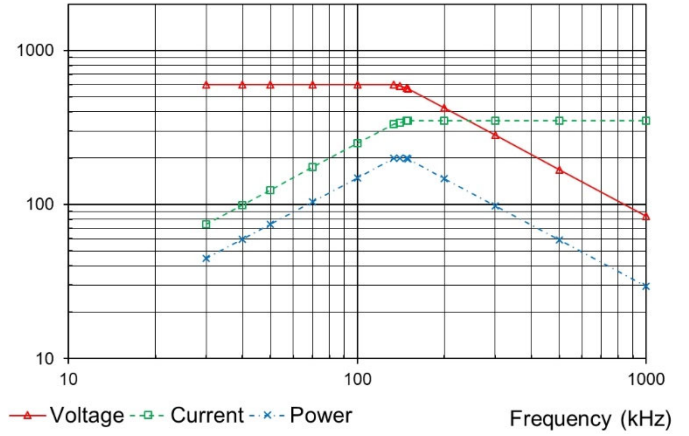

CC2-6U1334F 1.33uF 600Vrms 450A 200kVAR

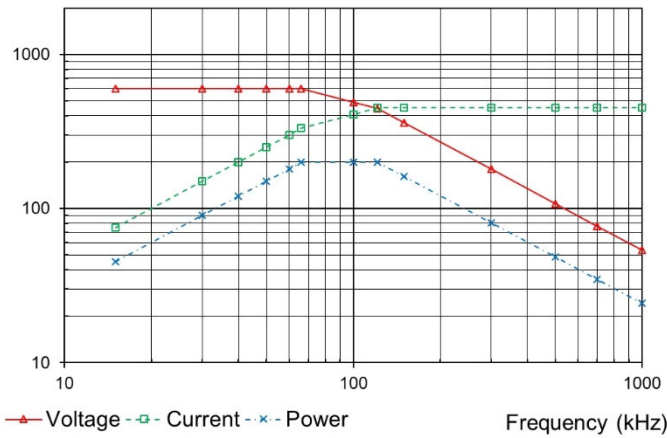

CC2-4U2404F 2.4uF 450Vrms 500A 200kVAR

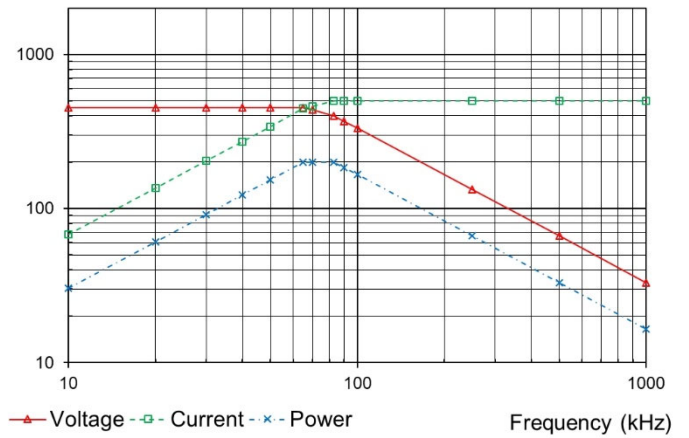

Derating Curves:

300 kVAr

CC3-10U2003A 0.2uF 1000Vrms 500A 300kVAR

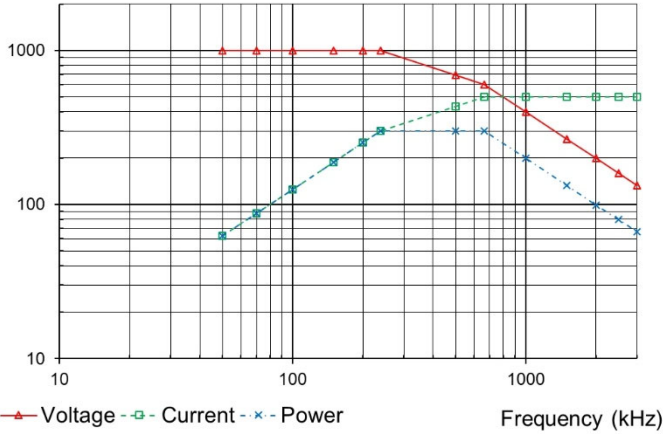

CC3-7U6603A 0.66uF 700Vrms 500A 300kVAR

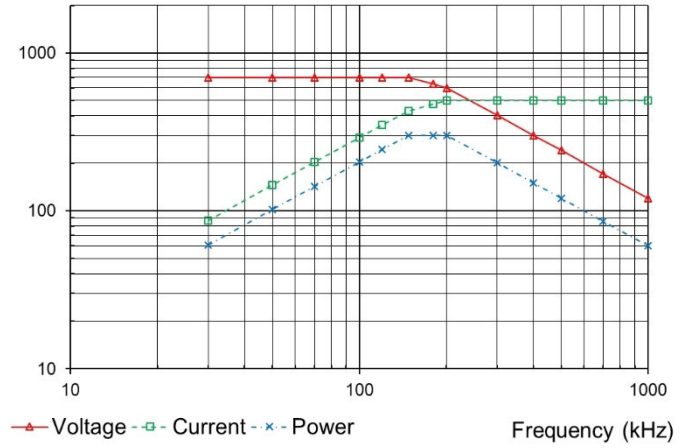

CC3-6U1004G 1uF 600Vrms 650A 300kVAR

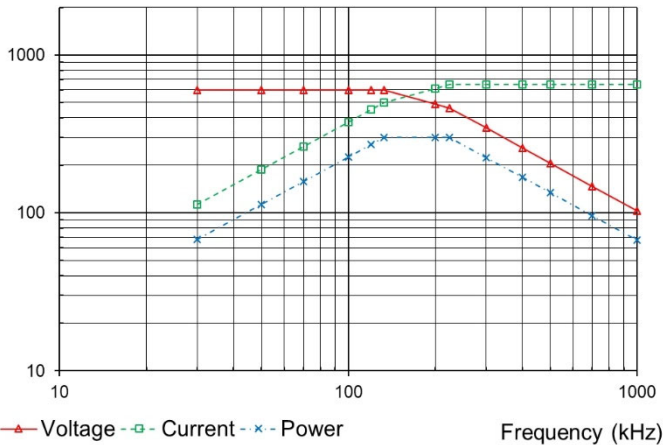

CC3-6U1304G 1.3uF 600Vrms 650A 300kVAR

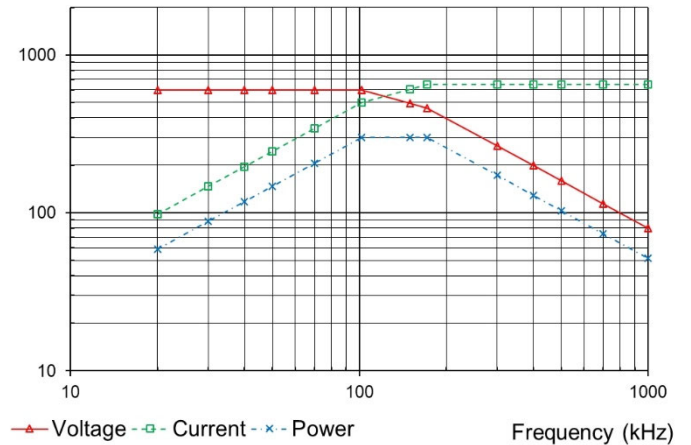

CC3-5U2604G 2.6uF 500Vrms 650A 300kVAR

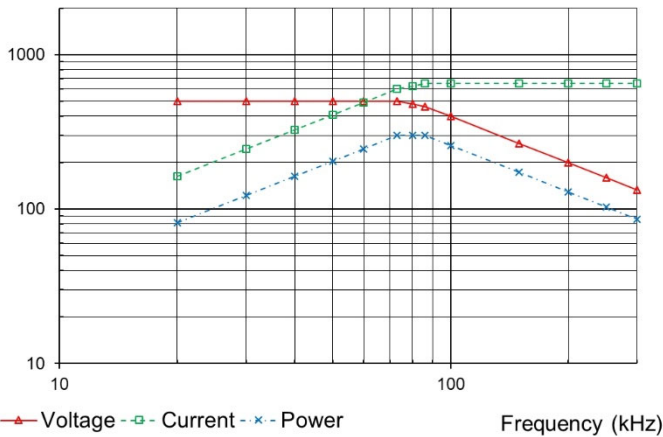

CC3-4U5004A/D/G 5uF 400Vrms 800A 300kVAR

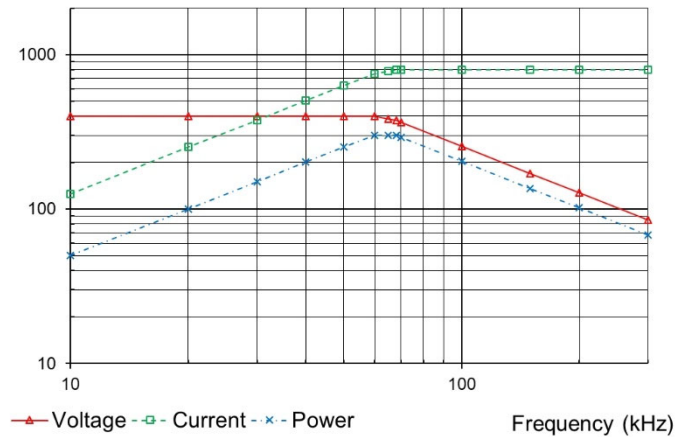

Derating Curves:

400 kVAR

CC4-10U1003D 0.1uF 1000Vrms 400A 400kVAR

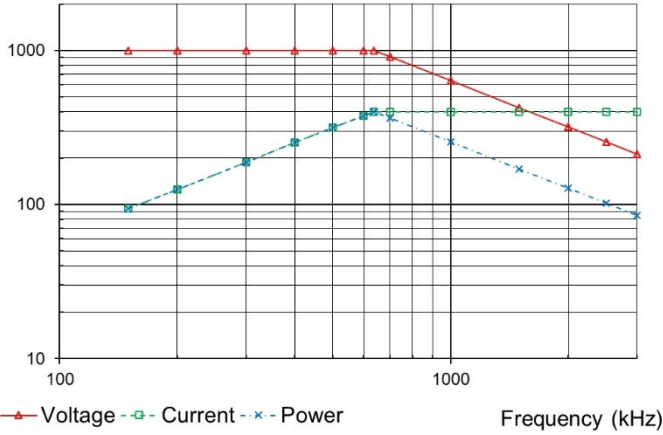

CC4-10U2003D 0.2uF 1000Vrms 400A 400kVAR

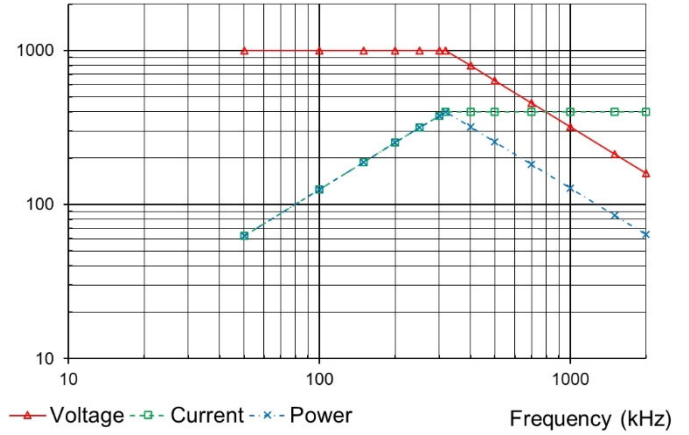

CC4-10U3303A/B/D 0.33uF 1000Vrms 600A 400kVAR

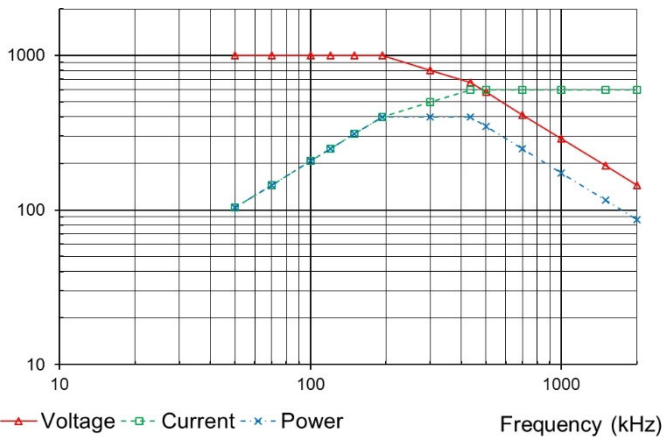

CC4-10U6603A/D 0.66uF 1000Vrms 600A 400kVAR

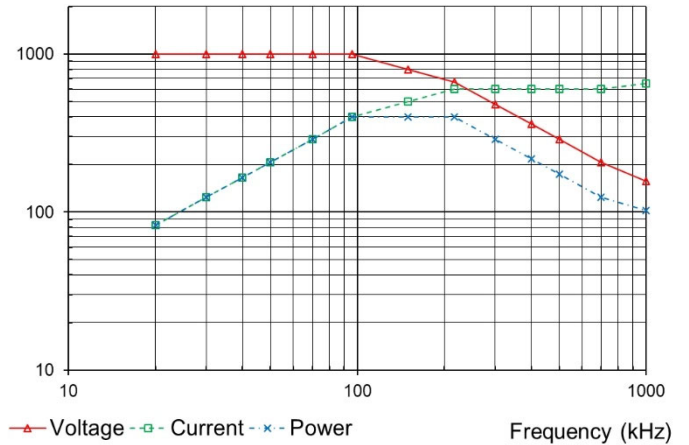

CC4-8U1004D 1uF 800Vrms 650A 400kVAR

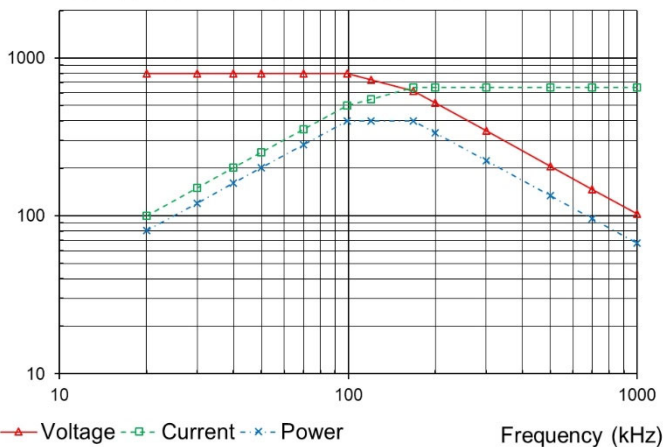

CC4-9U1334D 1.33uF 900Vrms 850A 400kVAR

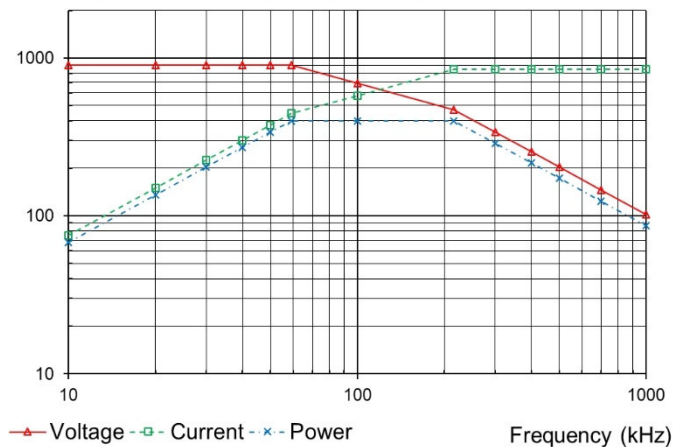

Derating Curves:

400 kVAR

CC4-7U2604A/D 2.6uF 700Vrms 950A 400kVAR

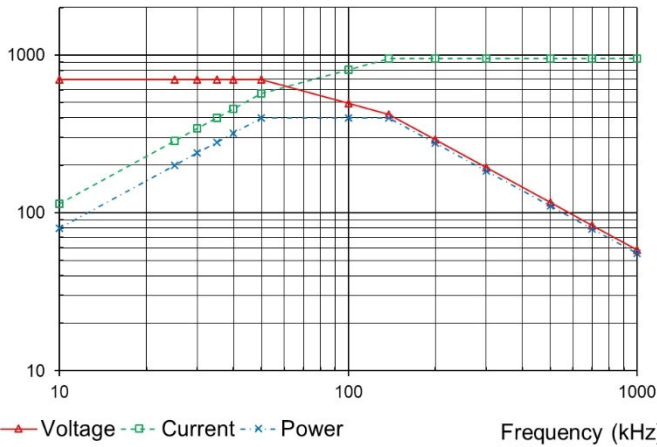

CC4-5U5004A/D 5uF 500Vrms 1000A 400kVAR

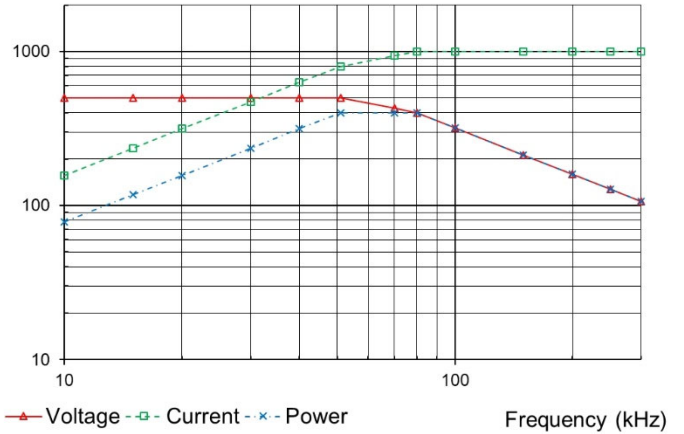

500 kVAR

CC5-11U1404C 1.4uF 1100Vrms 600A 500kVAR

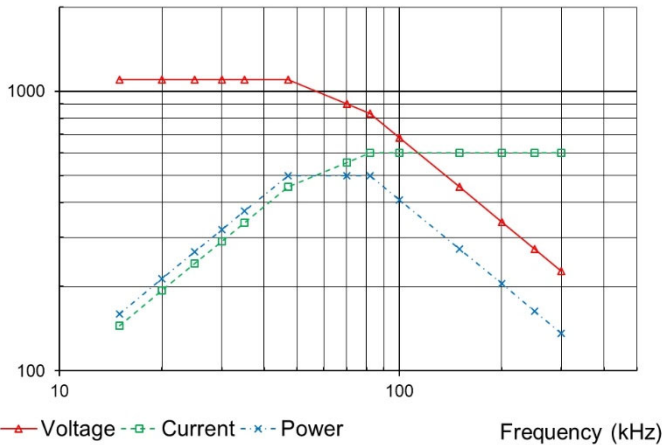

CC5-7U6304H 6.3uF 700Vrms 1000A 500kVAR

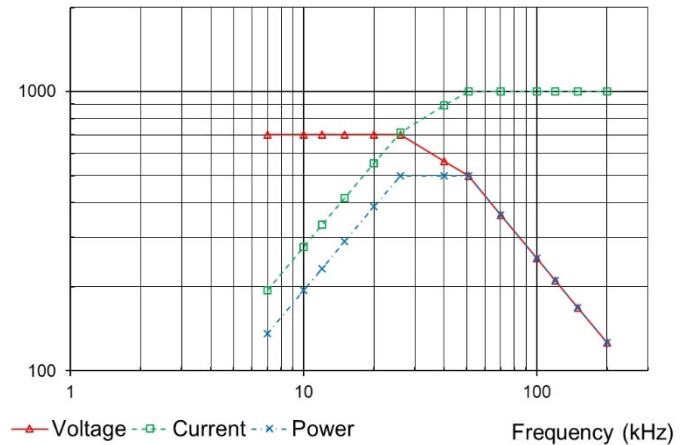

CC5-7U8504H 8.5uF 700Vrms 1000A 500kVAR

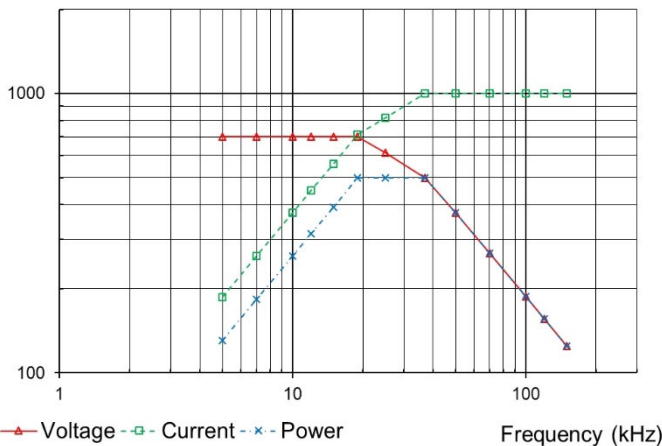

CC5-7U1005C 10uF 700Vrms 1000A 500kVAR

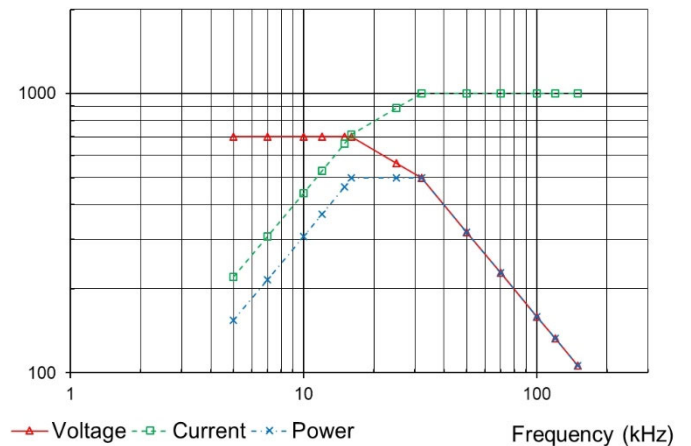

Derating Curves:

600 kVAr

CC6-10U3303D 0.33uF 1000Vrms 600A 600kVAR

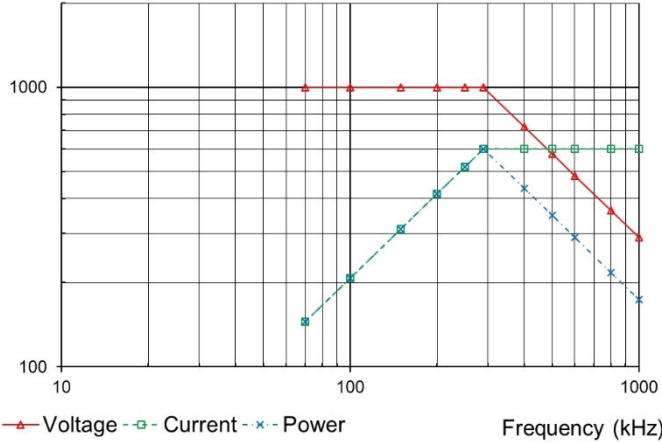

CC6-10U6603C 0.66uF 1000Vrms 700A 600kVAR

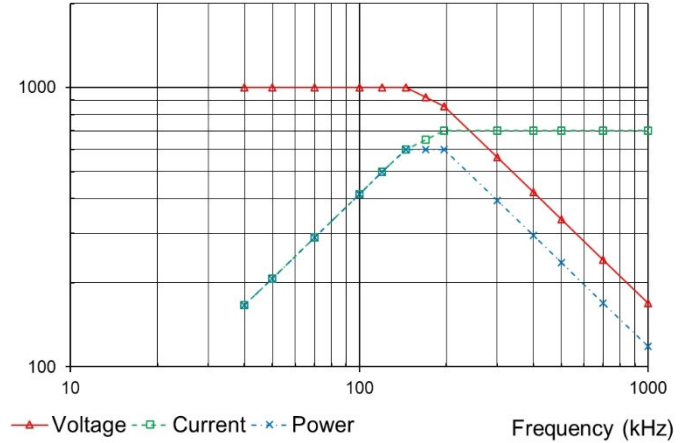

CC6-7U1334D 1.33uF 700Vrms 950A 600kVAR

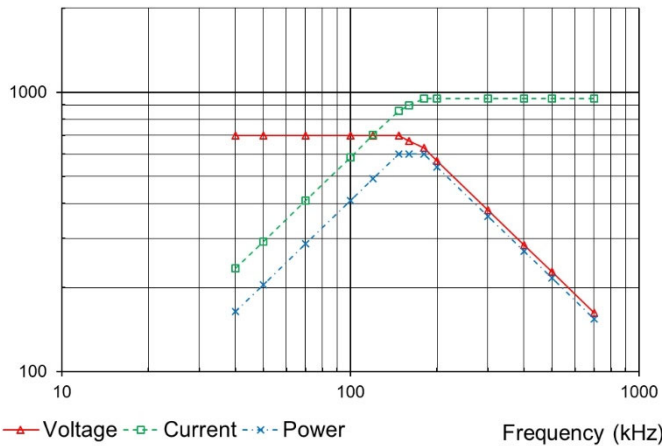

CC6-7U2604C 2.6uF 700Vrms 1050A 600kVAR

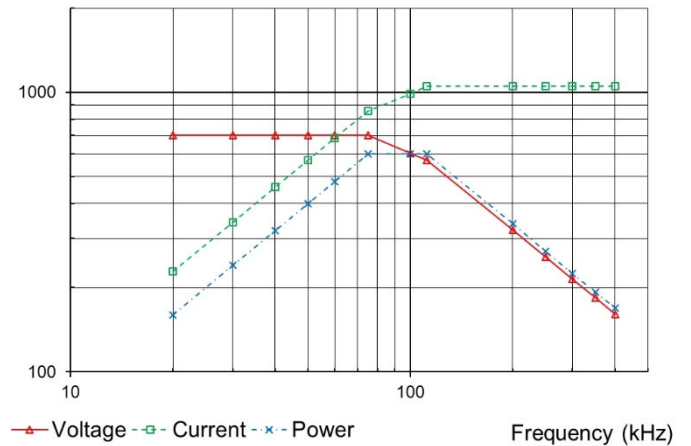

CC6-5U5004C/D 5uF 500Vrms 1200A 600kVAR

